

T20 TIG-Welding Torch.

The robust high-quality classic torch



TIG-Welding Torch

The tried and tested TIG welding torch generation:

- Lightweight torch body is less fatiguing and increases operator comfort
- High-temperature silicone rubber insulation provides best protection against high frequency leakage
- Efficient cooling design extends torch life
- Light and flexible cable assemblies
- Multiple configurations of wear parts meet the demands of nearly any application
- Consumables are compatible to the international standard

LINDE welding torches incorporate the high quality and technology needed for trouble-free performance whatever the welding job. All the torches have been thought through down to the last detail and guarantee exact and comfortable work.

T20 (Liquid cooled)

For welding alloyed steels, aluminium, magnesium, copper and their alloys, grey cast iron, bronzes, nickel, silver, titanium, lead and unalloyed steels.

Arguments speaking for themselves:

- Tried and trusted technology
- Optimum torch cooling
- Light and flexible cable assembly
- Wearing parts compatible with international standard

Technical data according to EN 60 974-7:

Cooling:	Liquid cooled
Rating:	220 A DC
	170 A AC
	100% duty cycle
Electrodes-Ø:	0.5 – 3.2 mm

Wear- and Sparepart List

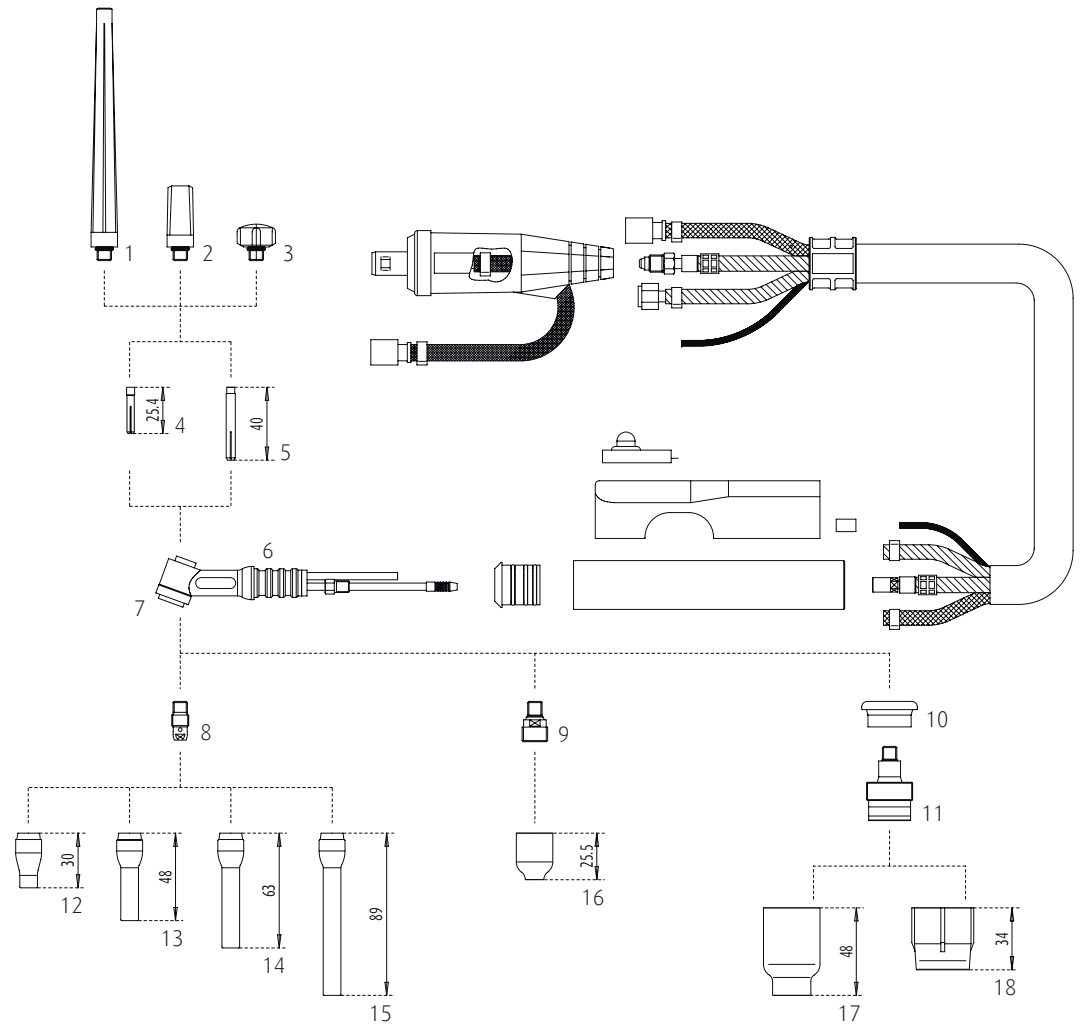

Wear parts

Pos.	Description			Linde PN
1	Back Cap	long	41V24	40/00204-L
2	Back Cap	medium	41V35	40/00202-L
3	Back Cap	short	41V33	40/00201-L
4	Collet	1.0 x 25.0 mm	13N21	40/00302-L
	Collet	1.6 x 25.0 mm	13N22	40/00303-L
	Collet	2.4 x 25.0 mm	13N23	40/00304-L
	Collet	3.2 x 25.0 mm	13N24	40/00305-L
5	Collet	1.0 x 40.0 mm	13N21L	40/00341-L
	Collet	1.6 x 40.0 mm	13N22L	40/00342-L
	Collet	2.4 x 40.0 mm	13N23L	40/00343-L
	Collet	3.2 x 40.0 mm	13N24L	40/00344-L

Adress of the respective country

Wear parts

Pos.	Description		Linde PN
6	Torch Body	SR-20	40/00104-L
7	Insulator	598882	40/00601-L
8	Collet Body	0.5-1.0 mm	13N26
	Collet Body	1.6 mm	13N27
	Collet Body	2.4 mm	13N28
	Collet Body	3.2 mm	13N29
9	Collet Body with gas lens	0.5-1.0 mm	45V41/45V42
	Collet Body with gas lens	1.2 mm	
	Collet Body with gas lens	1.6 mm	45V43
	Collet Body with gas lens	2.0 mm	
	Collet Body with gas lens	2.4 mm	45V44
	Collet Body with gas lens	3.2 mm	45V45
10	Adaptor	54N63-20	40/00602-L
11	Collet Body with Jumbo gas lens	0.5-1.0 mm	45V0204S
	Collet Body with Jumbo gas lens	1.6 mm	45V116S
	Collet Body with Jumbo gas lens	2.4 mm	45V64S
	Collet Body with Jumbo gas lens	3.2 mm	995795S
12	Gas Nozzle, Ceramic	Size 5, 30 mm	13N08
	Gas Nozzle, Ceramic	Size 6, 30 mm	13N09
	Gas Nozzle, Ceramic	Size 7, 30 mm	13N10
	Gas Nozzle, Ceramic	Size 8, 30 mm	13N11
	Gas Nozzle, Ceramic	Size 9, 30 mm	13N12
	Gas Nozzle, Ceramic	Size 10, 30 mm	13N13
13	Gas Nozzle, Ceramic	Size 4, 48 mm	796F71
	Gas Nozzle, Ceramic	Size 5, 48 mm	796F72
	Gas Nozzle, Ceramic	Size 6, 48 mm	796F73
14	Gas Nozzle, Ceramic	Size 4, 63 mm	796F75
	Gas Nozzle, Ceramic	Size 5, 63 mm	796F76
15	Gas Nozzle, Ceramic	Size 4, 89 mm	796F79
16	Gas Nozzle, Ceramic	Size 4, 25.5 mm	53N58
	Gas Nozzle, Ceramic	Size 5, 25.5 mm	53N59
	Gas Nozzle, Ceramic	Size 6, 25.5 mm	53N60
	Gas Nozzle, Ceramic	Size 7, 25.5 mm	53N61
17	Gas Nozzle, Ceramic	Size 6, 48 mm	57N75
	Gas Nozzle, Ceramic	Size 8, 48 mm	57N74
	Gas Nozzle, Ceramic	Size 10, 48 mm	53N88
	Gas Nozzle, Ceramic	Size 12, 48 mm	53N87
18	Gas Nozzle, Ceramic	34 mm	53N89

Adress of the respective country

Adress of the respective country
